

版本：V2.1

本圖面若與目錄之規格尺寸不符，以本圖面規格尺寸為主。

Below is our main specification if different from catalog.

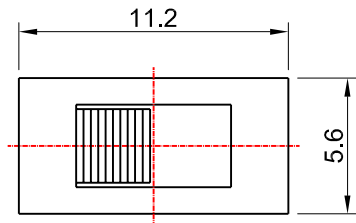

P.C.B LAYOUT

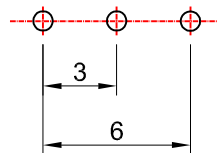

SCHEMATIC (NON-SHORTING)

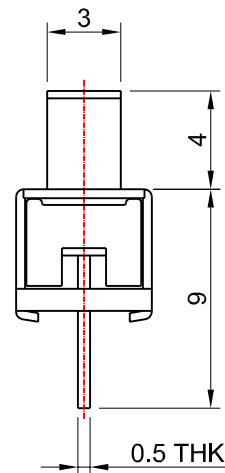
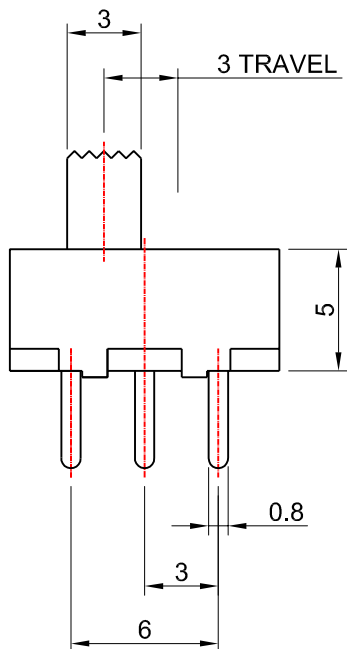
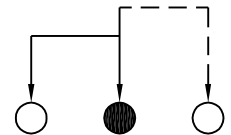

SS12F20GX

OPTIONAL KNOB SIZE (L)
3 - 12

SPECIFICATION

Rating: 0.3A 30V DC.

Contact resistance: 30mΩ.

Insulation resistance: 100MΩ at 500V DC.

Withstand voltage: AC 500V for 1 minute.

Switching life: 10,000 Cycles (unloading/15-18 Cycles per minute).

Tolerance: .XX=±0.2mm, .X=±0.3mm.



產品 PRODUCT		SLIDE SWITCH		型號 MODEL NO.		SS12F20G4	
比例 SCALE	單位 UNIT	版本 VER.	日期 DATE	SWITRONIC 一綺電子企業股份有限公司 INDUSTRIAL CORP. Switches ISO 9001			
3:1	mm	V2.0	2004.03.05				
製圖 DRAWN	核圖 CHECKED	主管 APPROVED		(110) 台北市信義路4段415號12樓之2 12F-2 NO. 415, SEC.4, HSIN YI ROAD, TAIPEI, TAIWAN TEL:886-2-27290229(Rep.) FAX:886-2-27582086 E-Mail: switches@ms36.hinet.net			
Daniel Lee	Alex Lin	Margaret Lee					

一綺電子企業股份有限公司

SWITRONIC INDUSTRIAL CORP.

MODEL NO.: SS SERIES

V2.0

DATE: 2003/12/09

SPECIFICATION

TITEL: SLIDE SWITCH

1. RATING: 0.3A 30V DC
2. FUNCTUIN: 1P2T
3. TIMING: NON-SHORTING

ITEM	TEST CONDITIONS	PERFORMANCE
4.ELECTRICAL PERFORMANCE		
4A	CONTACT RESISTANCE	BEING MEADURED AT 1KHz±200Hz AT NO LOAD.
		30mΩ MAX
4B	INSULATION RESISTANCE	APPLY DC 500V BETWEEN ANY TWO OPEN TERMINALS AND BETWEEN THE TERNINAL AND THE FRAME FOR 1 MINUTE.
		100MΩ MIN
4C	WITHSTAND VOLTAGE	APPLY AC 500V (50-60Hz) BETWEEN ANY OPEN TERMINALS AND BETWEEN THE TERNINAL AND THE FRAME FOR 1 MINUTE.
		SHALL BE FREE FROM DIELECTIC BREAKAGE.

5.MACHANICAL PERFORMANCE		
5A	OPERATION FORCE	BY DRAWING WITH MEASUREMENT
5B	TERMINAL STRENGTH	A STATIC FORCE OF 500gf BEING APPLIED IN CNE DIRECTION ON THE TOP OF THE TERMINAL FOR 1 MINUTE.
		THE TERMINAL NAY BE DEFORMED BUT SHALL NOT SUSTAIN ANY TROUBLE AS DEVIATION AND BREAKING OF INSULATION MATERIAL ELECTRICAL PERFORMANCE OF THE ABOVE ITEM 4 SHALL BE ASSURED.
5C	LEVER STRENGTH	A STATIC FORCE OF 1kgf SHALL BE APPLIED IN THE DIRECTION OF OPERATION
		THE DEFORMATION SHALL NOT BE EXTREME AND THE LEVER SHALL MECHANICALLY WORK NORMALLY.

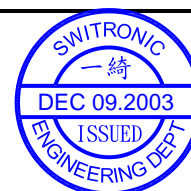

		FOR 1 MINUTE.	
--	--	---------------	--

6.DURABILITY			
6A	LIFE TEST	10,000 CYCLES OPERATION AT A RATE OF 15-18 CYCLES PER MINUTE WITHOUT LOAD.	1.CONTACT RESISTANCE:100MΩ MAX 2.INSULATION RESISTANCE: 50MΩ MIN 3.WITHSTAND VOLTAGE:AC 500V,1Min 4.OPERATION FORCE:±30% INITIAL VALUE. 5.THERE SHALL BE NO DEFECTS IN APPEARANCE OR IN THE MECHANICAL FUNCTIONS.
6B	HEAT TEST	80±2 FOR 96 HOURS. AFTER TEST KEPT IN NORMAL CONDITION FOR 30 MINUTE	WITHOUT HARMFUL DAMAGE IN APPEARANCE, MECANICAL AND ELECTRICAL CHARACTERISTICS SHALL BE SATISFIED. CONTACT RESISTANCE:50mΩ MAX.
6C	HUMIDITY TEST	40±2 ,90-95% RH FOR 96 HOURS. AFTER TEST KEPT IN NORMAL CONDITION FOR 30 MINUTE.	
6D	COLD TEST	-30 ±3 FOR 96 HOURS. AFTER TEST KEPT IN NORMAL CONDITION FOR 30 MINUTES.	INSULATION RESISTANCE:50 MΩ MIN.
6E	SOLDERABILITY TEST	THE TOP OF THE TERMINALS SHALL BE DIPPED 2mm IN THE SOLDER BATH OF 230±10 FOR 3±0.5 SECONDS.	A NEW UNIFORM COATION OF SOLDER SHALL COVER A MINIMUM OF 90% OF THE SURFACE BEING IMMersed.
6F	RESISTANCE TO SOLDERING HEAT TEST	THE TOP OF THE TERMINALS SHALL BE DIPPED 2mm IN THE SOLDER BATH OF 230±10 FOR 3±0.5 SECONDS.	WITHOUT HARMFUL DAMAGE IN APPEARANCE, MECANICAL AND ELECTICAL CHARACTERISTICS SHALL BE SATISFIED.
6G	PRACTICAL TEMPERATURE RANG	-15 TO +60	

